



# SIMPLY STAINLESS

Modular Sinks, Tables & Shelving



| SPECIFICATION |  |
|---------------|--|
| Tops          | <ul style="list-style-type: none"> <li>- High quality stainless steel.</li> <li>- 1.2mm gauge, no. 4 Finnish.</li> <li>- Double skinned.</li> </ul>  |
| Drawers       | <ul style="list-style-type: none"> <li>- high quality stainless steel w/lock.</li> <li>- 1.2mm gauge, no. 4 Finnish.</li> </ul>  |
| Body          | <ul style="list-style-type: none"> <li>- Full double skinned and welded construction.</li> <li>- Open to RHS.</li> <li>- Mid shelf to LHS.</li> <li>- Double skinned doors to front.</li> <li>- Full piano hinge.</li> </ul> |
| Feet          | <ul style="list-style-type: none"> <li>- 4 x Castors (2x locking, 2x non locking).</li> <li>- Plate mounted nylon.</li> </ul>  |

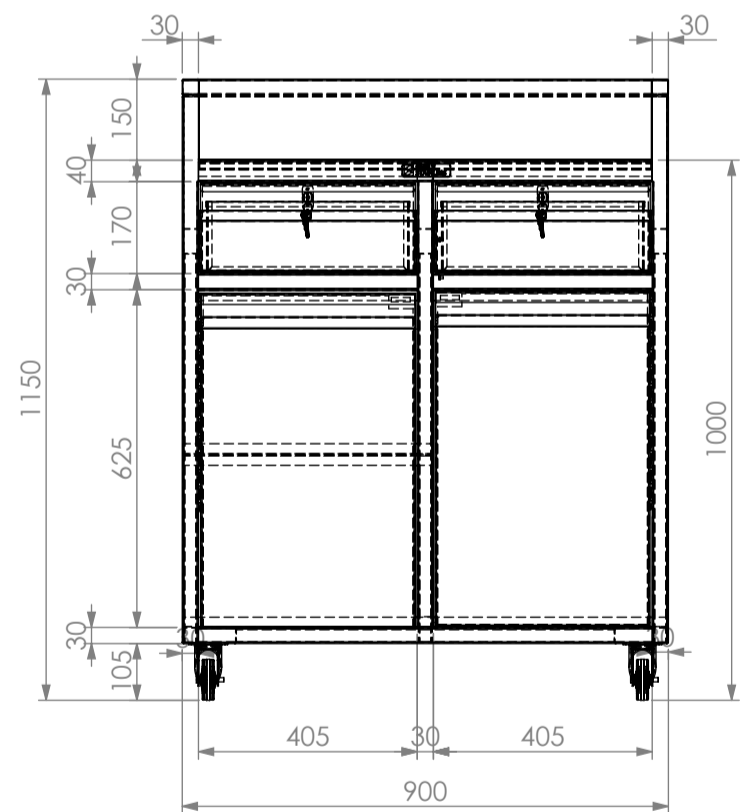

| 40 | Waiters Station |                 |                  |                    |
|----|-----------------|-----------------|------------------|--------------------|
|    | Product Code    | Dimensions (mm) | Unit weight (Kg) | Load capacity (Kg) |
|    | 40-WS           | 900x600x1150    | 87               | 160                |

